



ECU 14

ECU 16

ECU 18

ECU 20

ECU technical data.

Low lift pallet trucks



This specification sheet to VDI 2198 guidelines states only the technical data for the standard equipment. Different tyres, other masts, additional equipment etc. could result in different values.

Characteristics	1.1	Manufacturer			STILL	
	1.2	Manufacturer's model designation			ECU 14	
	1.3	Power supply			Electric	
	1.4	Operation type: hand, pedestrian, stand-on, sit-on, order picker			Pedestrian	
	1.5	Capacity/load	Q	t	1,4	
	1.6	Nominal load centre	c	mm	600	
	1.8	Load distance	x	mm	914	
	1.9	Wheelbase	y	mm	1275	
	Weight	2.1	Weight (incl. Battery)		kg	325
2.2		Axle loadings laden	Drive side/load side	kg	591/1134 ¹	
2.3		Axle loadings unladen	Drive side/load side	kg	251/74 ¹	
Wheels, Tyres	3.1	Tyres (rubber, pneumatic, polyurethane)			Polyurethane	
	3.2	Tyre size	Drive side	mm	230 x 75	
	3.3	Tyre size	Load side	mm	85 x 100	
	3.4	Castor wheels (size)	Drive side	mm	ø 100/40	
	3.5	Wheels, number (x=drive wheel)	Drive side/load side		1x - 2/2	
	3.6	Track width	Drive side	b ₁₀	mm	458
	3.7	Track width	Load side	b ₁₁	mm	350/390/510
Dimensions	4.4	Lift		h ₃	mm	123
	4.9	Height of tiller in drive position	Min./max.	h ₁₄	mm	800/1240
	4.15	Forks height lowered		h ₁₃	mm	85
	4.19	Overall Length		l ₁	mm	1660
	4.20	Length to front face of forks		l ₂	mm	510
	4.21	Overall width		b ₁	mm	720
	4.22	Forks dimensions		s/e/l	mm	52/170/1150
	4.25	Forks external width		b ₅	mm	520/560/680
	4.32	Floor clearance, centre of wheelbase		m ₂	mm	36
	4.33	Working aisle width for pallets 1000 x 1200 crosswise		A _{st3}	mm	1771 ⁴
4.34	Working aisle width for pallets 800 x 1200 lengthwise (b ₁₂ x l ₆)		A _{st3}	mm	1971 ⁴	
4.35	Outer turning radius		W _a	mm	1485 ⁴	
Performances	5.1	Traveling Speed	Laden/unladen	km/h	5/5	
	5.2	Lifting Speed/Time	Laden/unladen	m/s	0,039/0,047	
	5.3	Lowering Speed/Time	Laden/unladen	m/s	0,072/0,028	
	5.8	Max. gradeability laden	Laden/unladen	%	10,0/25,0	
	5.10	Service brakes			Electric	
Electric motors	6.1	Drive motor, rating S2 = 60 min		kW	1,0	
	6.2	Lift motor, rating at S3 = 15%		kW	1,0	
	6.3	Battery to IEC 254-2; A, B, C, no			/	
	6.4	Battery voltage, capacity K _S		V/Ah	2 x 12/44	
	6.5	Battery weight ± 5% (dependant on manufacturer)		kg	36,4	
Others	8.1	Drive control			Electronic	
	8.4	Noise peak at operator's ears		dB (A)	< 70	

¹ With batteries 12 V/44 Ah

² With battery 24 V/150 Ah

³ With battery 24 V/250 Ah

⁴ Value referred to truck with creep speed button ON, and tiller arm rotate of 90°

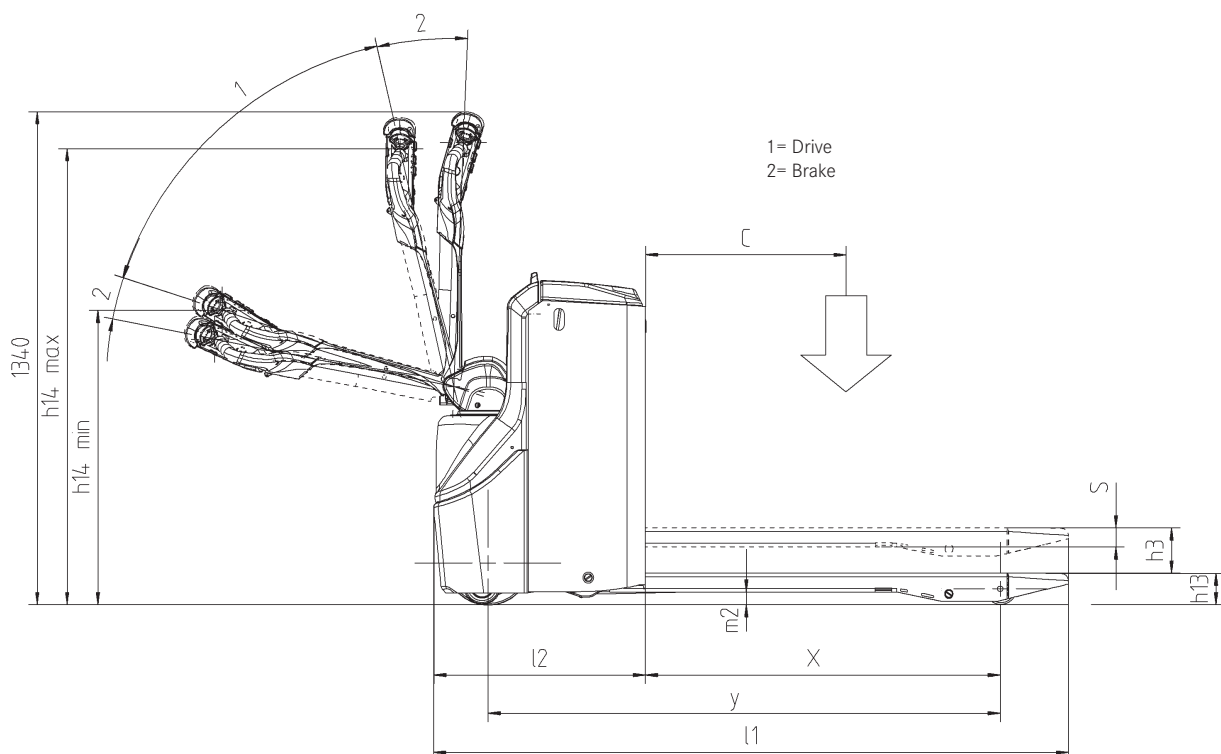

STILL	STILL	STILL	STILL	STILL
ECU 16		ECU 18		ECU 20
Electric	Electric	Electric	Electric	Electric
Pedestrian	Pedestrian	Pedestrian	Pedestrian	Pedestrian
1,6	1,6	1,8	1,8	2,0
600	600	600	600	600
914	914	914	914	914
1275	1342	1275	1342	1342
432	512	432	512	512
723/1309 ²	762/1350 ³	772/1460 ²	808/1503 ³	855/1657 ³
336/96 ²	395/117 ³	336/96 ²	395/117 ³	395/117 ³
Polyurethane	Polyurethane	Polyurethane	Polyurethane	Polyurethane
230 x 75	230 x 75	230 x 75	230 x 75	230 x 75
85 x 100	85 x 100	85 x 100	85 x 100	85 x 100
ø 100/40	ø 100/40	ø 100/40	ø 100/40	ø 100/40
1x - 2/2	1x - 2/2	1x - 2/2	1x - 2/2	1x - 2/2
458	458	458	458	458
350/390/510	350/390/510	350/390/510	350/390/510	350/390/510
123	123	123	123	123
800/1240	800/1240	800/1240	800/1240	800/1240
85	85	85	85	85
1660	1727	1660	1727	1727
510	577	510	577	577
720	720	720	720	720
52/170/1150	52/170/1150	52/170/1150	52/170/1150	52/170/1150
520/560/680	520/560/680	520/560/680	520/560/680	520/560/680
36	36	36	36	36
1771 ⁴	1838 ⁴	1771 ⁴	1838 ⁴	1838 ⁴
1971 ⁴	2038 ⁴	1971 ⁴	2038 ⁴	2038 ⁴
1485 ⁴	1552 ⁴	1485 ⁴	1552 ⁴	1552 ⁴
6/6	6/6	6/6	6/6	6/6
0,039/0,047	0,039/0,047	0,039/0,047	0,039/0,047	0,039/0,047
0,087/0,037	0,087/0,037	0,044/0,044	0,044/0,044	0,044/0,044
8,0/25,0	8,0/25,0	7,3/25,0	7,3/25,0	6,6/25,0
Electric	Electric	Electric	Electric	Electric
1,0	1,0	1,0	1,0	1,0
1,0	1,0	1,0	1,0	1,0
British Standard	DIN 43535 B	British Standard	DIN 43535 B	DIN 43535 B
24/110 (150)	24/200 (250)	24/110 (150)	24/200 (250)	24/200 (250)
123 (152)	150 (220)	123 (152)	150 (220)	150 (220)
Eletronic	Eletronic	Eletronic	Eletronic	Eletronic
< 70	< 70	< 70	< 70	< 70

Forks			British Standard battery compartment			DIN Standard battery compartment		
l	c	x	y	l1	Wa	y	l1	Wa
mm	mm	mm	mm	mm	mm	mm	mm	mm
980	500	744	1105	1490	1315	1172	1557	1382
1150	600	914	1275	1660	1485	1342	1727	1552
1450	750	1214	1575	1960	1784	1642	2027	1851
1600	800	1364	1725	2110	1934	1792	2177	2001

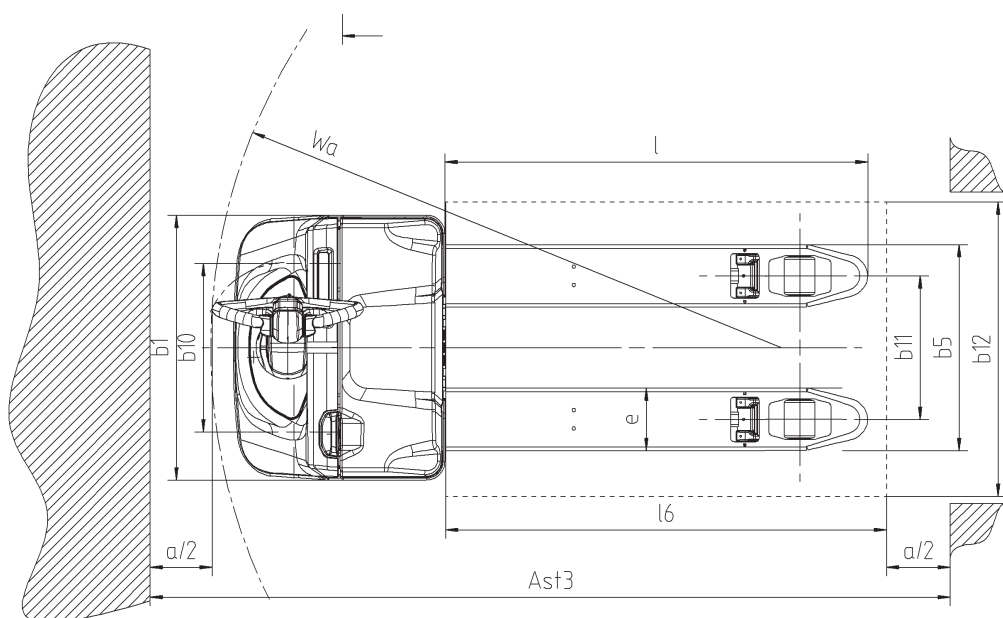



Easily operated by both left and right-handed users



Clear display of battery condition and operating hours



Practical layout provides good fork tips visibility



The ECU is right at home transporting goods horizontally for industry, trade and commerce



Simply practical.

ECU low lift pallet trucks have a load capacity of 1400-2000 kg and are dependable companions for transporting goods horizontally. As the entry-level equipment for light tasks, the ECU 14 offers a built-in maintenance-free gel battery and an integrated charger.

Construction.

- The compact battery compartment comprises one continuous plate so provides optimal protection for the batteries.
- The robust bodywork is constructed from heavy duty polyurethane that is able to withstand impacts without permanent deformation or breakage.

Tiller.

- The shape of the tiller together with its ergonomic grip and buttons facilitates easy operation by both right-handed and left-handed users.
- The tiller's shape is designed to ensure the best possible operating position in even the tightest spaces.
- The new tiller greatly reduces operator fatigue. When released the tiller will reposition itself to its vertical position.
- The impact switch on the tiller head prevents operators becoming trapped. Should the operator touch the impact switch the ECU will automatically switch from forward to reverse.

Drive.

- The 1KW three-phase drive gives even power output whether the equipment is laden or empty. The maintenance-free AC technology contributes to low energy and maintenance costs.
- RF control on all models.
- The control system enables energy to be recovered when the drive switch is released and during regenerative braking.
- The ECU has an hour meter with discharge indicator fitted as standard.

Brakes.

- The ECU has two different braking systems:
- A reverse current brake
 - An electromagnetic emergency brake controlled by a micro switch actuated at the two tiller end positions.

Battery.

- Two different battery trays allow batteries of capacities from 24V/150Ah to 24V/250Ah to be accommodated.
- The batteries are easily accessible.
- The ECU 14 has two maintenance-free 12V/44Ah gel batteries.

Load rollers.

- Single polyurethane rollers are fitted as standard.
- Tandem rollers are optionally available.

Drive wheel.

- Polyurethane is provided as standard for long service life.
- A solid rubber drive wheel is optionally available.

Fork dimensions.

- Fork lengths are 980 mm, 1150 mm, 1450 mm, and 1600 mm.
- Fork widths are 520 mm, 560 mm, and 680 mm.

Maintenance.

- Two lifting points are mounted on the frame to enable the equipment to be safely raised by crane hooks.
- All parameters relating to the drive, electrical braking system, and electrical functions are configurable and can be modified in accordance with customer-specific individual requirements through STILL Customer Services.

Options.

- Access control via PIN code entry.
- Creep speed mode for manoeuvring in tight spaces.
- Integrated on-board charger.



Наши контакты

ООО "Торговый Дом Техника для Склада"

Москва: Нагорный проезд, дом № 10 А

Телефон: +7 (495) 545-31-74

Санкт-Петербург: ул. Боровая, д. 44, лит. А

Телефон: +7 (812) 303-80-30

Более подробную информацию Вы найдете на сайте:

www.tdtts.ru